

**TOWN OF EATONIA
BYLAW NO. 7/08**

A BYLAW TO REGULATE WALLS, FENCES,
HEDGES OR SHRUBS ALONG A LOT LINE

The Council of the Town of Eatonia, in the Province of Saskatchewan, enacts as follows:

Walls, fences, hedges or shrubs may be erected, placed, planted, maintained or grown along a lot line only in conformance with the following regulations:

1. Residential Districts (Diagram "A")

- (a) No wall, fence, hedge or shrubs located along any lot line, other than those in a required front yard, shall exceed two (2) metres (6.56 feet) in height.
- (b) No wall, fence, hedge or shrub located along any lot line in a required front yard shall exceed one (1) metre (3.28 feet) in height.
- (c) In the case of a corner lot, no wall, fence, hedge or shrub shall exceed 0.75 metres (2.46 feet) in height in an intersection sight triangle.
- (d) In the case of corner lots, no fence, hedge, shrub or wall shall be placed so as to create a visual obstruction in an established sight triangle. The sight triangle in a front yard shall not exceed 7.5 metres (25 feet) in length on the corner lot lines (front and both side property lines).

2. Commercial Districts

- (a) No fence, hedge or shrub, other than those required as screening shall exceed two (2) metres (6.56 feet) in height.
- (b) In the case of corner lots, no fences, hedge or shrubs shall be placed so as to create a visual obstruction in an established sight triangle.

- 3. The use of electrified or barb wire as a fencing material within the town limits must be approved by town council.

Dated at Eatonia, Saskatchewan, this 18th day of June, 2008.

Mayor

{SEAL}

Administrator

Read a third time and adopted
this 18th day of June 2008.

Administrator

**TOWN OF EATONIA
DIAGRAM "A"
FORMING PART OF BYLAW NO. 7/08**

**WALL, FENCE, HEDGE
OR SHRUB REQUIREMENTS**

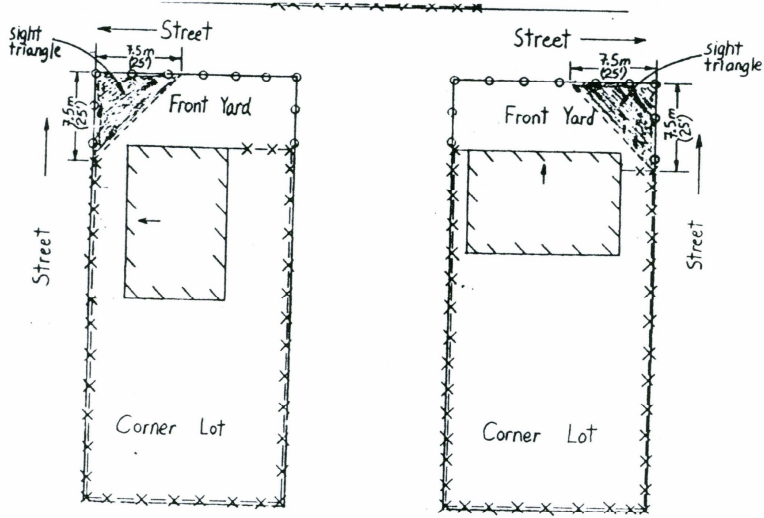
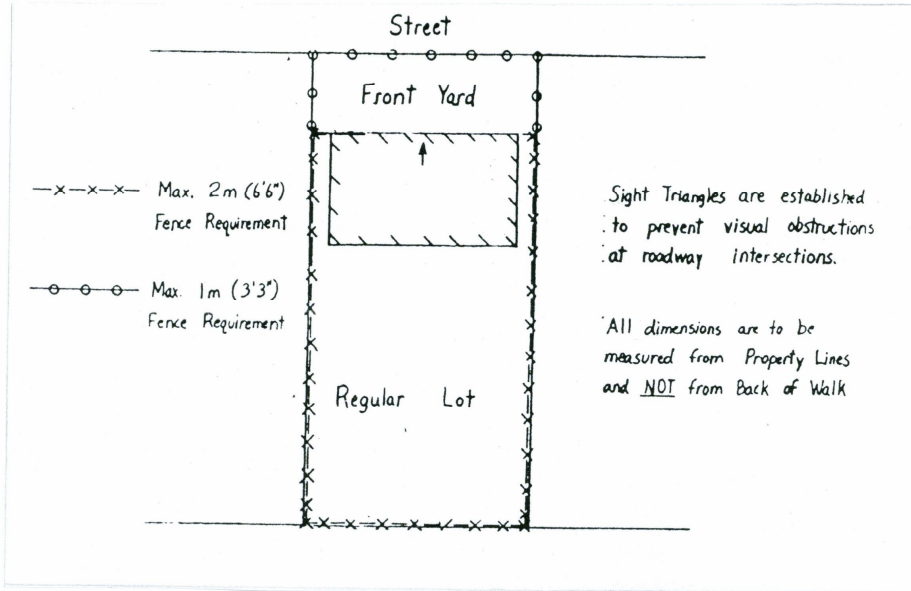

For Residential Areas Only